

REFERENCE SHEET

Office buildings



Building:

**Head-office building
INDUSTRIAL PARK
TROLLI PLZEŇ**

Construction period:

2000

Investor:

TROLLI BOHEMIA

Contract value:

total contract value
100,0 mil. CZK

Volume -area:

ground-floor space
11 600 sq.m.

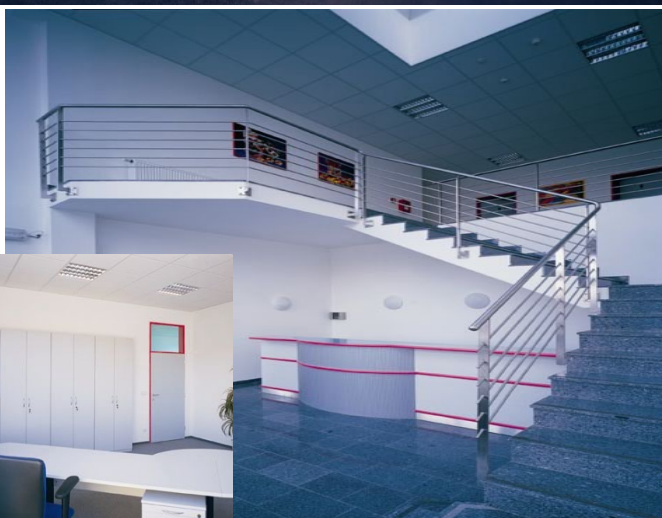

**Building
competence**

HEBERGER CZ s.r.o.

Pod Lysinami 518/28, 147 00 PRAHA 4

Sídlo dle OR: Průmyslová 5, 108 50 PRAHA 10

T: +420 244 000 111, F: +420 244 000 112

E-mail: heberger@heberger.cz, www.heberger.cz